



Ideal for a family stay between Disneyland® Paris and Paris, the Novotel Marne-la-Vallée Noisy-le-Grand is a real space for living and escaping. Come and enjoy a heated outdoor swimming pool, a library area with board games and its arcade games areas with a giant screen and taste authentic cuisine in our modern restaurant with terrace.

📍 2 Allée Bienvenue
93160 Noisy-le-Grand

☎ 01 48 15 60 60

✉ h1536@accor.com

📅 Commercial service : Hubert Corinne
h1536-sb@accor.com

⊕ of the hotel

- Near RER A with direct access to Disneyland® Paris or Paris
- Secure covered parking with charging stations for electric vehicles
- Terrace with swimming pool
- Modern restaurant with fresh and seasonal products
- Family rooms of 25 m²
- Play area for children, relaxation area, library

Hotel labels

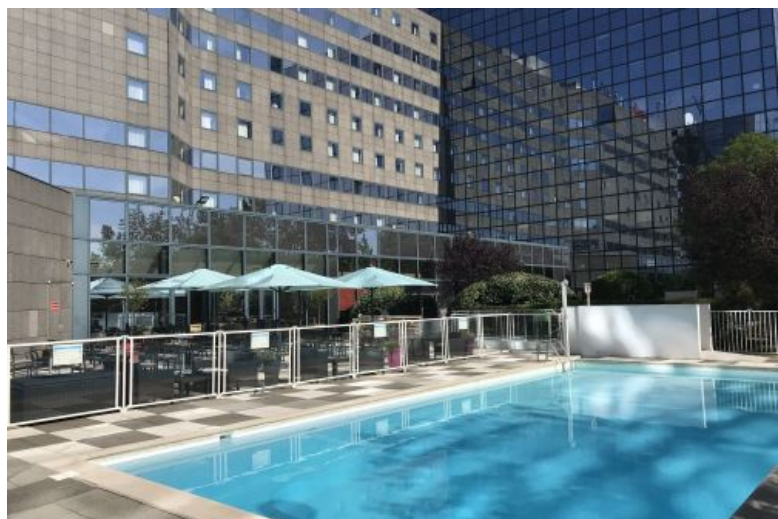

176 ROOMS



21

Double (incl. Single)



32

Twins



53

Quadruple Families



70

Triple Families



Meeting rooms



On-site catering



Car park



Accessibility for people with reduced mobility



Bar



Pets accepted



Air conditioner

OTHER SERVICES

Leisure groups accepted, Swimming pool, Fitness, Terrace, Bus park, Breakfast Buffet, Charging stations for electric vehicles, Welcome tray, Video surveillance, Safe, Mini-bar, Luggage porter, Wifi

AROUND THE HOTEL

Transports :



Airport

Paris-Orly Airport **20km**

Paris-Charles de Gaulle Airport

30km



Public transports

RER A Noisy-le-Grand-Mont d'Est **800m**



Railway station

Marne-La-Vallée Chessy Station

20km

Points of interest :



Vincennes castle **9km**

The Valley Village **20km**

Paris **20km**

Disneyland® Paris Park **21km**

View the good deals of the hotel



